

CONTRACT NO.: DA00305 WBS ELEMENT: 2017CPT.01.06.20281.1, ETC.

DRAWN BY: BJT

STATE OF NORTH CAROLINA
DIVISION OF HIGHWAYS

DARE COUNTY

STATE	STATE PROJECT REFERENCE NO.	SHEET NO.	TOTAL NO.
N.C.	2017CPT.01.06.20281.1, ETC.	1	
STATE PROJ. NO.	F.A. PROJ. NO.	DESCRIPTION	
2017CPT.01.06.20281.1		MAP 1	
2017CPT.01.06.20281.2		MAP 2	
2017CPT.01.06.20281.3		MAP 3	
2017CPT.01.06.20281.4		MAP 4	
2017CPT.01.06.20281.5		MAP 5	
2017CPT.01.06.20281.6		MAP 6	
2017CPT.01.06.20281.7		MAP 7	
2017CPT.01.06.20281.8		MAP 8	



LOCATION: MAP 1 SR 1431 COLONY DRIVE FROM NC 12 TO END OF MAINTENANCE
 MAP 2 SR 1436 MONITOR LANE FROM SR 1431 TO NC 12
 MAP 3 SR 1434 COLONY COURT FROM SR 1431 TO CUL-DE-SAC
 MAP 4 SR 1435 GALLEON DRIVE FROM SR 1431 TO SR 1436
 MAP 5 SR 1439 BOSUN COURT FROM SR 1431 TO CUL-DE-SAC
 MAP 6 SR 1467 PARK DRIVE FROM NC 12 TO CUL-DE-SAC
 MAP 7 SR 1407 BLUEFISH COURT FROM SR 1278 TO CUL-DE-SAC
 MAP 8 SR 1285 TARPON LANE FROM SR 1279 TO CUL-DE-SAC

TYPE OF WORK: RESURFACING & SHOULDER RECONSTRUCTION

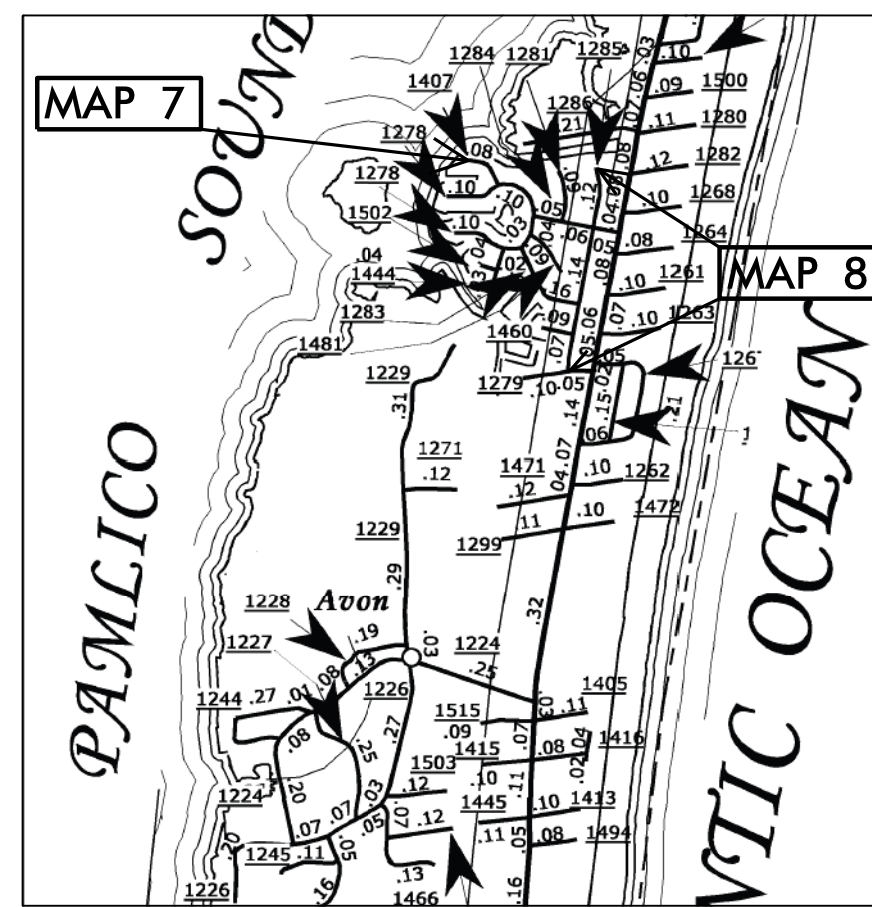
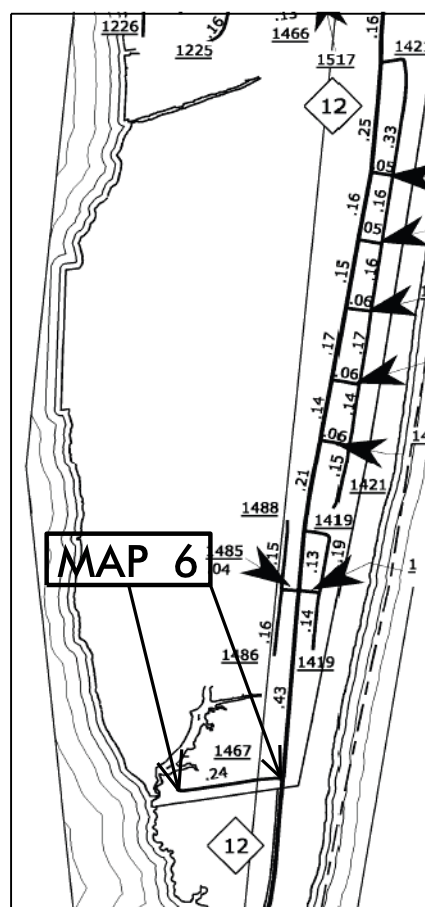
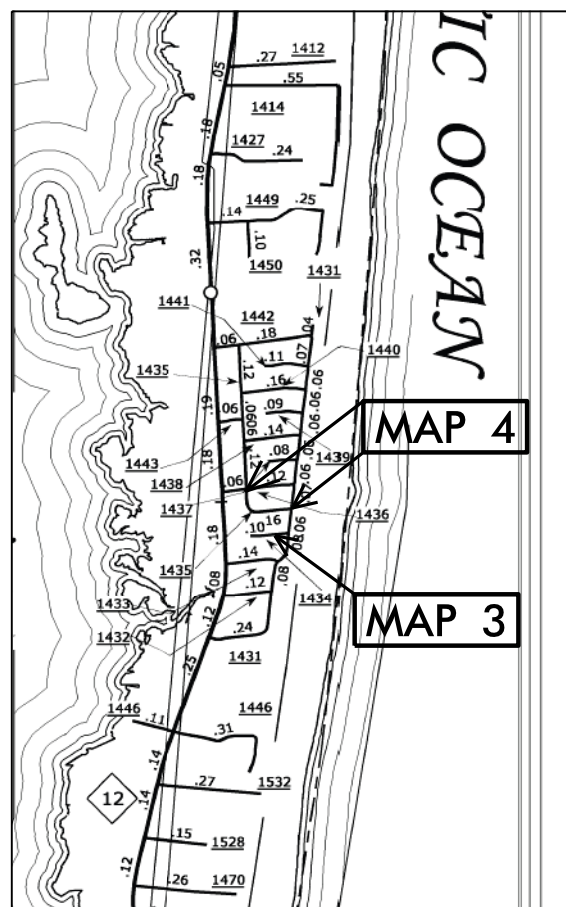
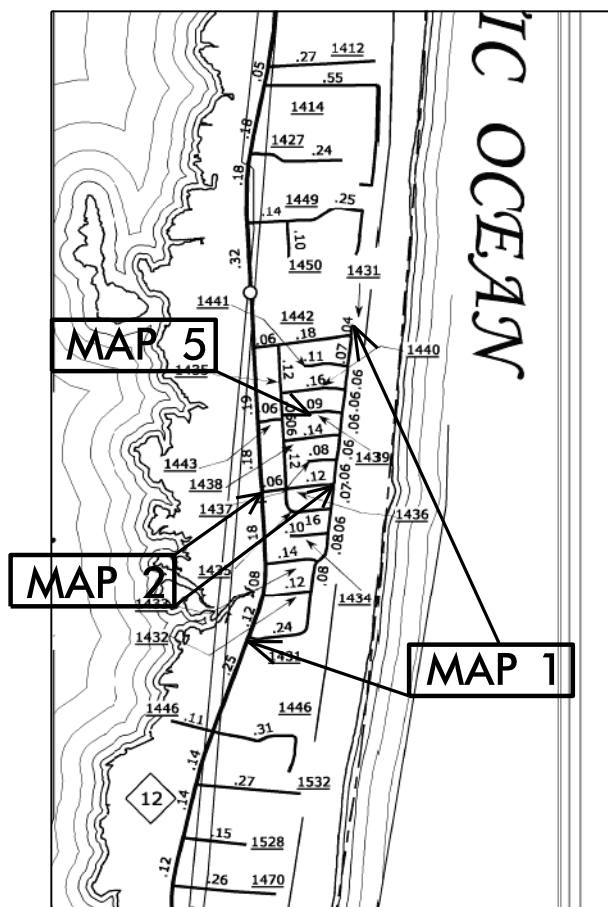

NTS

PROJECT LENGTH	
LENGTH OF ROADWAY PROJECT MAP 1	= 0.98 MI
LENGTH OF ROADWAY PROJECT MAP 2	= 0.17 MI
LENGTH OF ROADWAY PROJECT MAP 3	= 0.09 MI
LENGTH OF ROADWAY PROJECT MAP 4	= 0.15 MI
LENGTH OF ROADWAY PROJECT MAP 5	= 0.09 MI
LENGTH OF ROADWAY PROJECT MAP 6	= 0.24 MI
LENGTH OF ROADWAY PROJECT MAP 7	= 0.08 MI
LENGTH OF ROADWAY PROJECT MAP 8	= 0.27 MI

Prepared in the Office of:
DIVISION OF HIGHWAYS
 113 Airport Dr., Edenton NC, 27932

2012 STANDARD SPECIFICATIONS

LETTING DATE: _____

W. B. HOBBS, P.E.
DIVISION PROJECT MANAGER

C. E. SLACHTA
DIVISION PROPOSALS ENGINEER

DIVISION OF HIGHWAYS
STATE OF NORTH CAROLINA

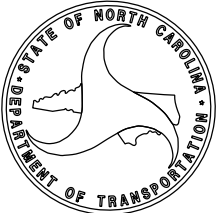

09/08/99

CONTRACT NO.: DA00305 WBS ELEMENT: 2017CPT.01.06.20281.1, ETC.

STATE OF NORTH CAROLINA
DIVISION OF HIGHWAYS

DARE COUNTY

STATE	STATE PROJECT REFERENCE NO.	SHEET NO.
N.C.	2017CPT.01.06.20281.1,ETC.	2
STATE PROJ.NO.	F.A.PROJ.NO.	DESCRIPTION
2017CPT.01.06.20281.9		MAP 9
2017CPT.01.06.20281.10		MAP 10
2017CPT.01.06.20281.11		MAP 11
2017CPT.01.06.20281.12		MAP 12
2017CPT.01.06.20281.13		MAP 13
2017CPT.01.06.20281.14		MAP 14
2017CPT.01.06.20281.15		MAP 15

LOCATION: MAP 9 SR 1279 BONITA ROAD FROM NC 12 TO DEAD END
 MAP 10 SR 1427 LAUGHING GULL LANE FROM NC 12 TO CUL-DE-SAC
 MAP 11 SR 1435 GALLEON DRIVE FROM SR 1436 TO SR 1442
 MAP 12 SR 1446 DORY ROAD FROM NC 12 TO DEAD END
 MAP 13 SR 1284 SEASHORE BOULEVARD FROM NC 12 TO SR 1278
 MAP 14 SR 1226 MCMULLEN ROAD FROM SR 1224 TO SR 1224
 MAP 15 SR 1226 MCMULLEN ROAD FROM SR 1224 TO CUL-DE-SAC

TYPE OF WORK: RESURFACING & SHOULDER RECONSTRUCTION

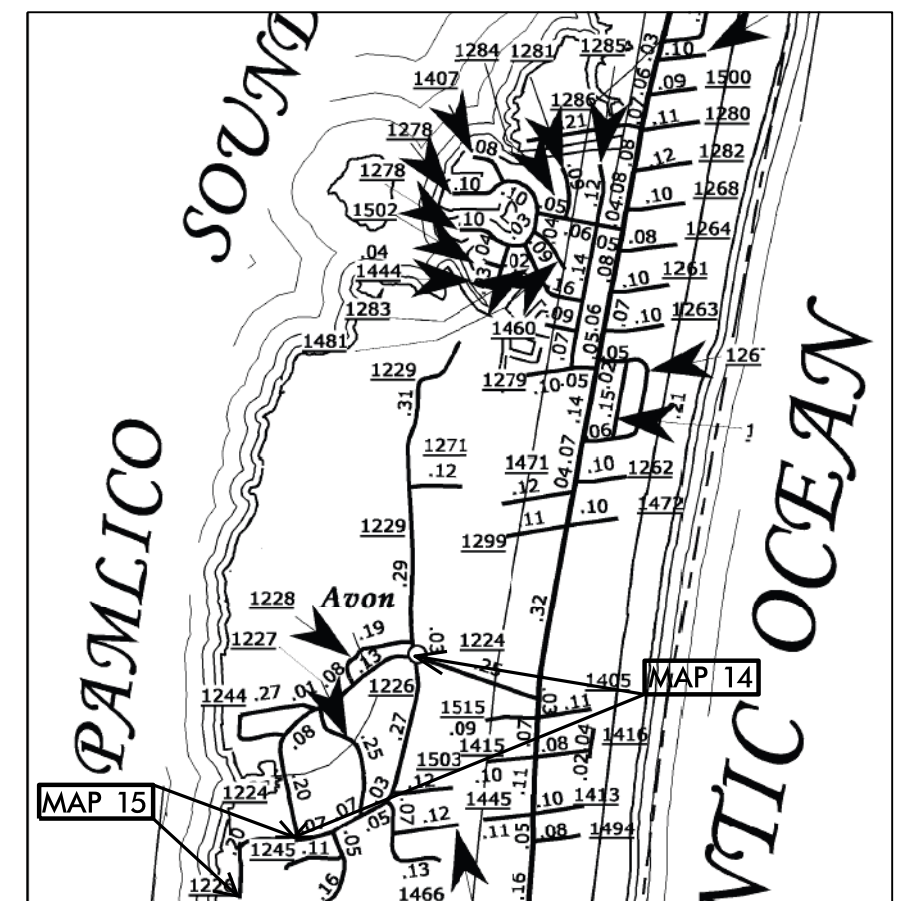
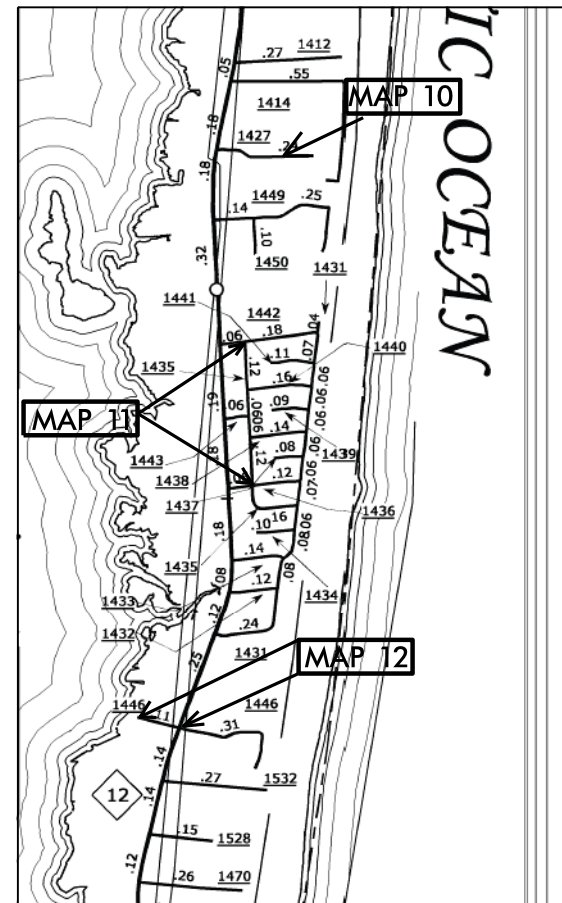
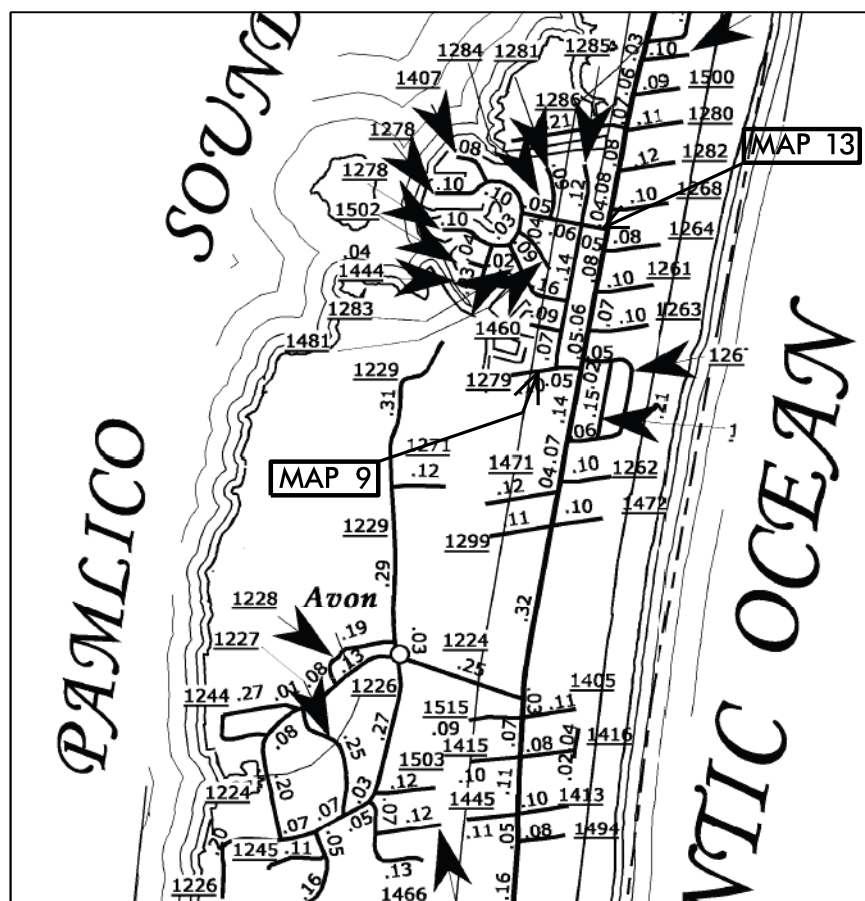

NTS

PROJECT LENGTH

- LENGTH OF ROADWAY PROJECT MAP 9 = 0.14 MI.
- LENGTH OF ROADWAY PROJECT MAP 10 = 0.23 MI.
- LENGTH OF ROADWAY PROJECT MAP 11 = 0.36 MI.
- LENGTH OF ROADWAY PROJECT MAP 12 = 0.10 MI.
- LENGTH OF ROADWAY PROJECT MAP 13 = 0.14 MI.
- LENGTH OF ROADWAY PROJECT MAP 14 = 0.55 MI.
- LENGTH OF ROADWAY PROJECT MAP 15 = 0.11 MI.

Prepared in the Office of:
DIVISION OF HIGHWAYS
 113 Airport Dr., Edenton NC, 27932

2012 STANDARD SPECIFICATIONS

LETTING DATE:

W. B. HOBBS, P.E.
 DIVISION PROJECT MANAGER

C. E. SLACHTA
 DIVISION PROPOSALS ENGINEER

DIVISION OF HIGHWAYS
 STATE OF NORTH CAROLINA

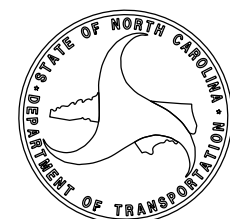

DRAWN BY: BJT

C O N T R A C T P A V E M E N T S C H E D U L E

C1	PROP. APPROX. 1½" ASPHALT CONCRETE SURFACE COURSE, TYPE SF9.5A, AT AN AVERAGE RATE OF 165 LBS. PER SQ. YD.
T	EARTH MATERIAL
U	EXISTING PAVEMENT

PAVEMENT SCHEDULE

C1	PROP. APPROX. 1½" ASPHALT CONCRETE SURFACE COURSE, TYPE SF9.5A, AT AN AVERAGE RATE OF 165 LBS. PER SQ. YD.
T	EARTH MATERIAL
U	EXISTING PAVEMENT.

PROJECT REFERENCE NO.	SHEET NO.
2017CPT.01.06.20281.1, ETC.	4

NOTES:

*ALL PAVED S.R. ROADS TO BE RESURFACED TO THE ENDS OF THE RADII, OR AS DIRECTED BY THE ENGINEER

*EDGES, PAVEMENT WIDENING, INTERSECTIONS, AND BRIDGE FLARES ARE INCLUDED IN THE TABLE OF QUANTITIES

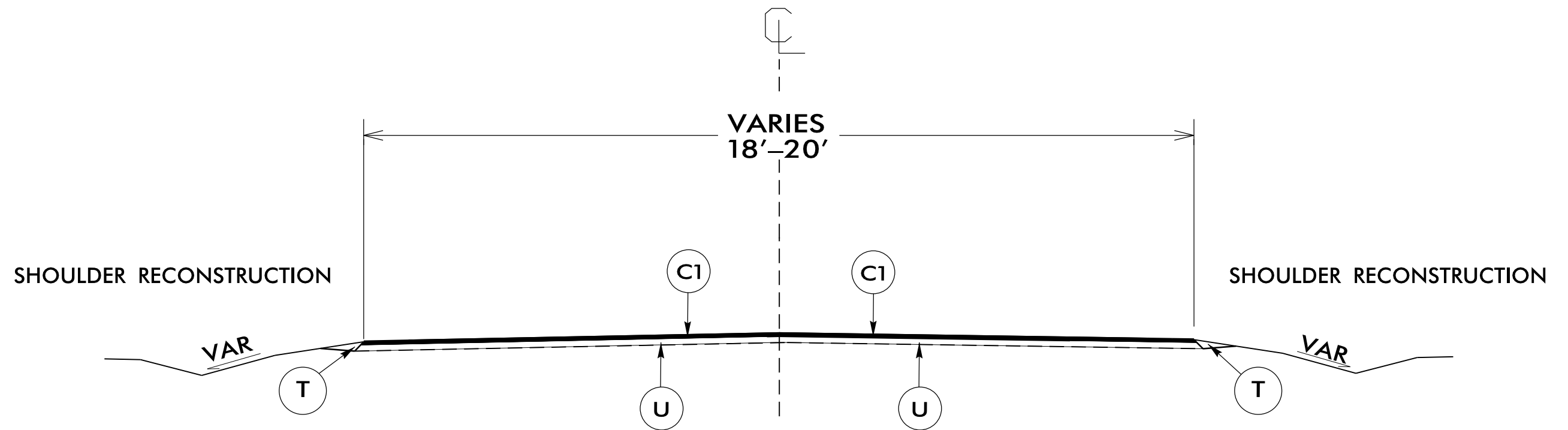

TYPICAL SECTION NO. 1

USE WITH MAPS 1 - 15

NTS

NOTES:

- 1) DETAIL DOES NOT APPLY TO OGAFB AND ULTRA-THIN BONDED WEARING COURSE.
- 2) BACKFILL SHOULDER WITH APPROVED MATERIAL.
- 3) THE SHOULDER WEDGE DEVICE MAY BE DISENGAGED AT PAVED DRIVEWAYS AND SIDE STREETS.

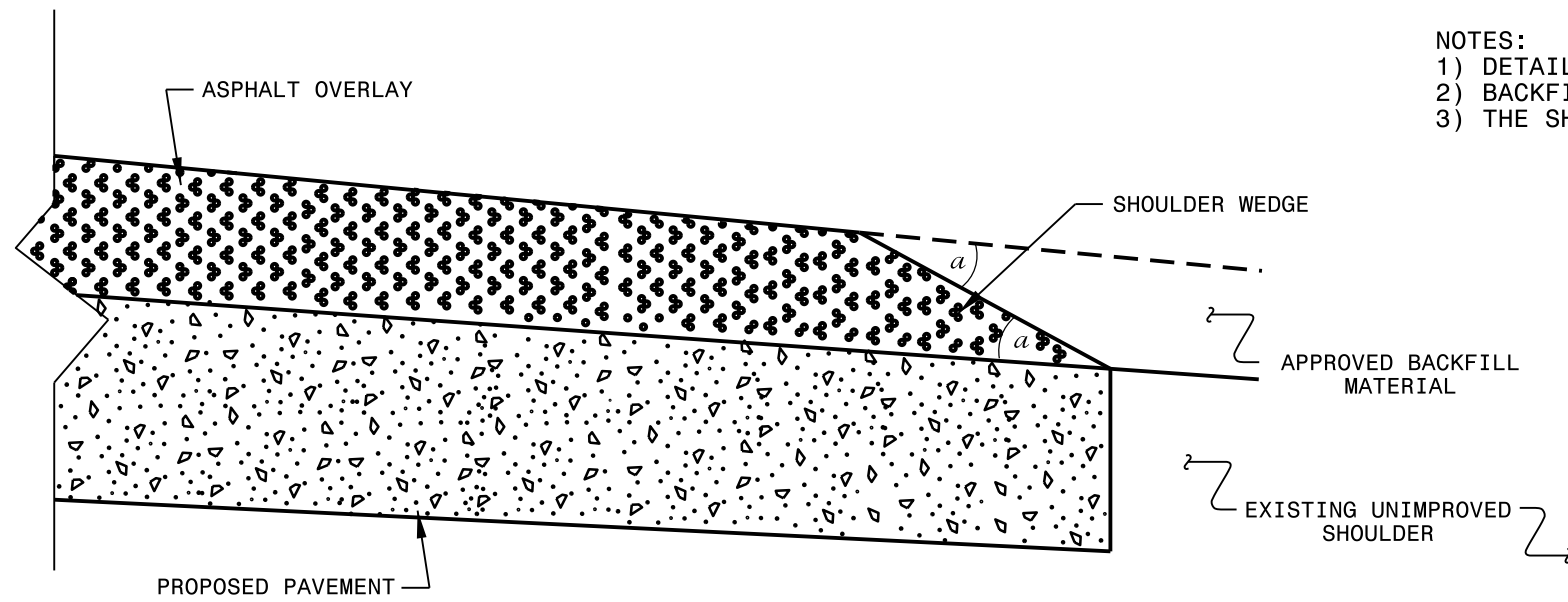

SHOULDER WEDGE DETAIL

(Resurfacing Projects w/ Widening or with Existing Paved Shoulder having no dropoffs)

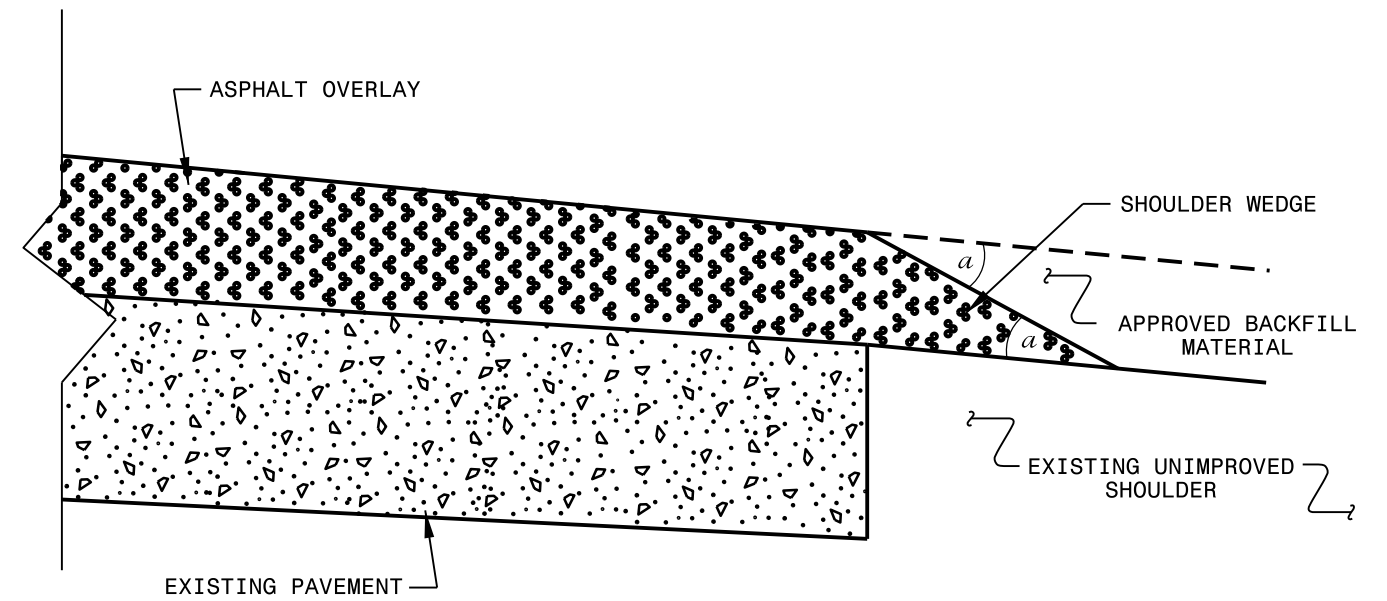

SHOULDER WEDGE DETAIL

(Resurfacing Projects w/ NO Widening)

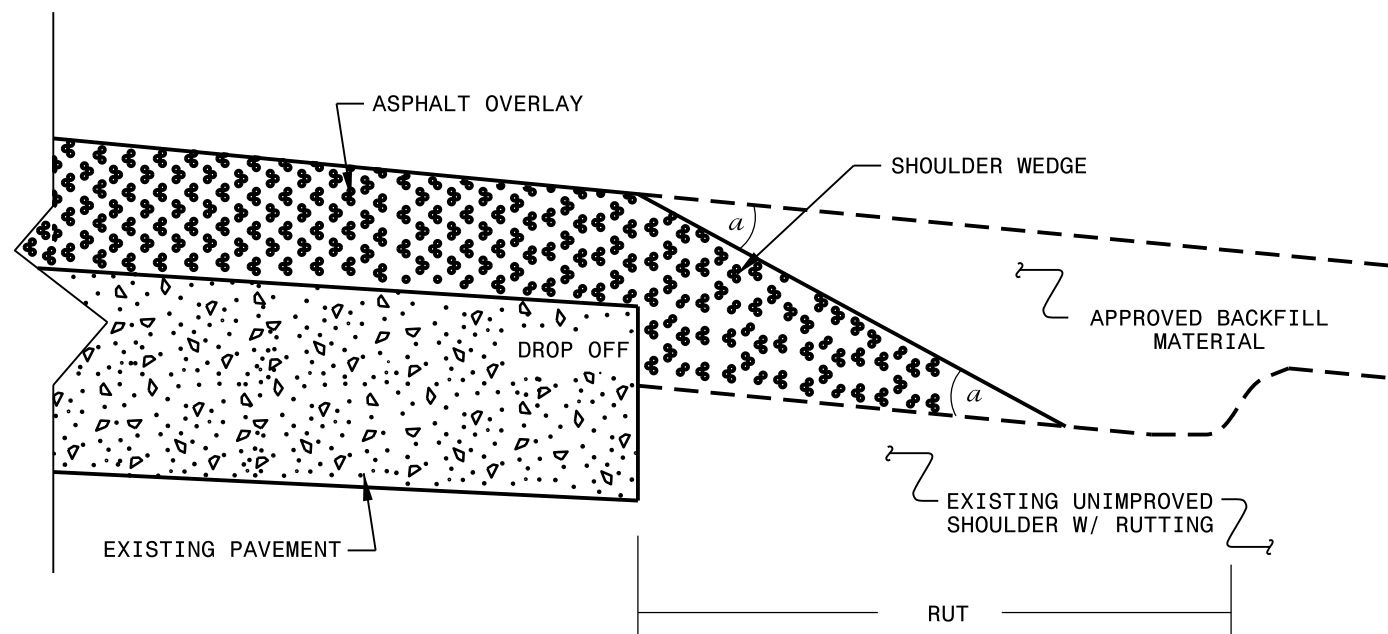

SHOULDER WEDGE DETAIL

(Resurfacing Adjacent to Rutted Shoulder)

- SHOULDER WEDGE ANGLE = 30°

CONTRACT STANDARDS AND DEVELOPMENT UNIT
Office 919-707-6950 FAX 919-250-4119

SHOULDER WEDGE DETAILS

ORIGINAL BY: T.SPELL DATE: 7-19-11
 MODIFIED BY: DATE: 10/16/12
 CHECKED BY: DATE:
 FILE SPEC.: s:\usr\details\stand\shoulderwedgedetail.dgn

SIGNING FOR RESURFACING PROJECTS

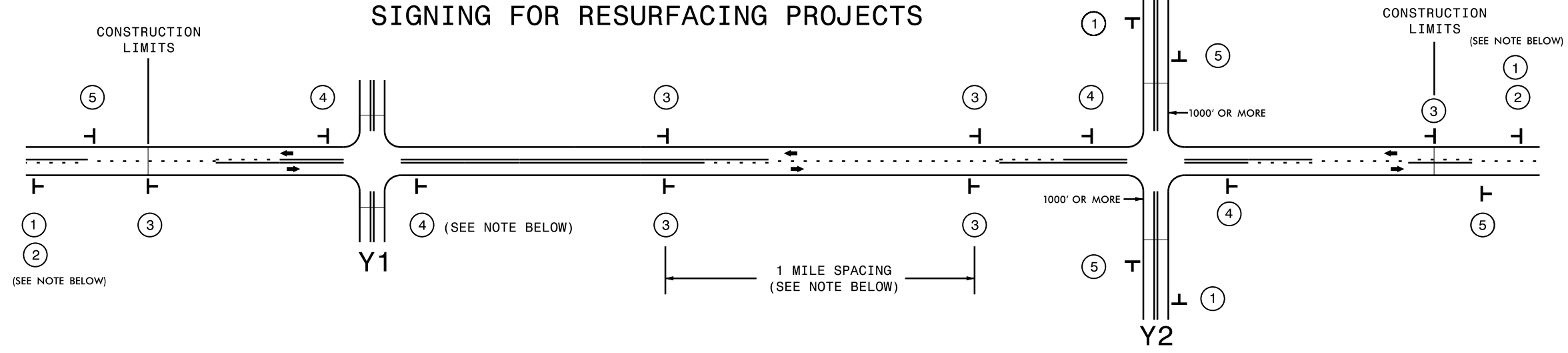

LEGEND

T STATIONARY SIGN

← DIRECTION OF TRAFFIC FLOW

MAINLINE (-L-) SIGNING

-Y- LINE SIGNING

SIGNING NOTES AND PLACEMENT PER DIRECTION	<p>①</p> <p>ROAD WORK AHEAD W20-1 48" X 48"</p> <p>②</p> <p>NEXT XX MILES W7-3aP 24" X 18"</p> <p>PLACE 1000' PRIOR TO BEGINNING OF CONSTRUCTION LIMITS. ONLY USED ON -Y- LINES IF RESURFACING LIMITS EXTEND 1000' ALONG -Y- LINE.</p> <p>#2 SIGN ONLY USED WHEN RESURFACING LIMITS ARE 2 OR MORE MILES IN LENGTH. ROUND UP TO NEXT WHOLE NUMBER. (NO FRACTIONAL OR DECIMAL NUMBERS)</p>	<p>NO REQUIRED STATIONARY SIGNING FOR THE FOLLOWING -Y- LINE CONDITIONS:</p> <ol style="list-style-type: none"> 1) LESS THAN 1000' OF RESURFACING ALONG -Y- LINE 2) SUBDIVISION ROADS 3) DEAD END ROADS <p>WHEN PAVING/CONSTRUCTION ACTIVITIES PROCEED ACROSS AN UNSIGNED -Y- LINE, ADVANCE WARNING PORTABLE SIGNS SHALL BE USED ALONG THE -Y- LINE AS SHOWN BELOW. REMOVE UPON COMPLETION OF WORK.</p> <p>PLACED 500' IN ADVANCE OF FLAGGER. PLACED 250' IN ADVANCE OF FLAGGER.</p>
	<p>③</p> <p>LOW/SOFT SHOULDER SP 13107 48" X 48"</p> <p>PLACE INITIALLY AT THE CONSTRUCTION LIMITS AND SPACED 1 MILE APART THEREAFTER. IF NO -Y- LINES EXIST, PLACE 2ND SET 1/2 MILE FROM THE CONSTRUCTION LIMITS AND THEN SPACE 1 MILE THEREAFTER.</p>	
	<p>④</p> <p>ROAD UNDER CONST SP 13106 48" X 48"</p> <p>THESE ARE FOR -Y- LINES THAT ARE "THROUGH" ROADWAYS. DEAD END AND SUBDIVISION ROADS ARE NOT "THROUGH" ROADWAYS. INSTALL 500' +/- FROM EACH -Y- LINE APPROACH AS SHOWN ABOVE. FOR MULTIPLE -Y- LINES THAT ARE SEPARATED BY 0.25 MILES OR LESS, TREAT AS A SINGLE UNIT AND INSTALL WITHIN 500' OF EACH APPROACH. A MAXIMUM OF 2 SIGN SETS PER MILE. DO NOT INSTALL WHEN -Y- LINES ARE WITHIN 0.5 MILES FROM "END ROAD WORK" SIGN.</p>	
	<p>⑤</p> <p>END ROAD WORK G20-2 A 48" X 24"</p> <p>PLACE 500' FOLLOWING THE END OF CONSTRUCTION LIMITS.</p>	

23-AUG-2016 11:08
 C:\cadd\35353\Drawings\Resurfacing\AdvWarn_2Ln.dgn
 dtatum AT D:\A02\0261



RESURFACING
ADVANCE WARNING SIGNS
FOR
RURAL AND SUBURBAN
2 LANE ROADWAYS

PROJECT NO.	SHEET NO.
2017CPT.01.06.20281.1, ETC.	7

SUMMARY OF QUANTITIES

PROJECT NO	COUNTY	MAP NO	ROUTE	DESCRIPTION	TYP NO	LANES	LANE TYPE	FINAL SURFACE TESTING REQUIRED	WARM MIX ASPHALT REQUIRED	LENGTH MI	WIDTH FT	MOBILIZATION LS	BORROW CY	INCIDENTAL STONE BASE TONS	SHOULDER RECONSTRUCTION SMI	SURFACE COURSE, SF9.5A TONS	ASPHALT BINDER FOR PLANT MIX TONS	ADJ. OF METER OR VALVE BOX EA	SEED & MULCHING AC	WORK ZONE SIGNS SF	TEMPORARY TRAFFIC CONTROL LS
2017CPT.01.06.20281.1	Dare	1	SR 1431 COLONY DR	FROM NC 12 TO END MAINT.	1	2	2WU	NO	NO	0.98	20	1	200	40	1.18	1,050	70		1.18	64	1
2017CPT.01.06.20281.2	Dare	2	SR 1436 MONITOR LN	FROM SR 1431 TO NC 12	1	2	2WU	NO	NO	0.17	19	*	40	5	0.35	173	12		0.21		*
2017CPT.01.06.20281.3	Dare	3	SR 1434 COLONY DR	FROM SR 1431 TO CUL-DE-SAC	1	2	2WU	NO	NO	0.09	20	*	20	2	0.19	96	6		0.11		*
2017CPT.01.06.20281.4	Dare	4	SR 1435 GALLEON DR	FROM SR 1431 TO SR 1436	1	2	2WU	NO	NO	0.15	19	*	20	4	0.31	153	10		0.19		*
2017CPT.01.06.20281.5	Dare	5	SR 1439 BOSUN ST	FROM SR 1431 TO CUL DE SAC	1	2	2WU	NO	NO	0.09	20	*	20	8	0.18	107	7		0.11		*
2017CPT.01.06.20281.6	Dare	6	SR 1467 PARK DR	FROM NC 12 TO CUL-DE-SAC	1	2	2WU	NO	NO	0.24	20	*	20	5	0.47	268	18		0.29	32	*
2017CPT.01.06.20281.7	Dare	7	SR 1407 BLUE FISH CT	FROM SR 1287 TO CUL-DE-SAC	1	2	2WU	NO	NO	0.08	19	*	20	6	0.16	92	6		0.10		*
2017CPT.01.06.20281.8	Dare	8	SR 1285 TARPON DR	FROM SR 1279 TO CUL-DE-SAC	1	2	2WU	NO	NO	0.27	19	*	100	15	0.53	297	20	2	0.32		*
2017CPT.01.06.20281.9	Dare	9	SR 1279 BONITO RD	FROM NC 12 TO DEAD END	1	2	2WU	NO	NO	0.14	18	*	20	10	0.27	146	10		0.17	32	*
2017CPT.01.06.20281.10	Dare	10	SR 1427 LAUGHING GULL LN	FROM NC 12 TO CUL-DE-SAC	1	2	2WU	NO	NO	0.23	19	*	100	4	0.47	262	18		0.28	32	*
2017CPT.01.06.20281.11	Dare	11	SR 1435 GALLEON DR	FROM SR 1436 TO SR 1442	1	2	2WU	NO	NO	0.36	20	*	100	10	0.71	402	27		0.43	64	*
2017CPT.01.06.20281.12	Dare	12	SR 1446 DORY RD	FROM NC 12 TO DEAD END	1	2	2WU	NO	NO	0.10	19	*	20	5	0.21	113	8		0.13	32	*
2017CPT.01.06.20281.13	Dare	13	SR 1284 SEASHORE BLVD	FROM NC 12 TO SR 1278	1	2	2WU	NO	NO	0.14	19	*	40	4	0.28	159	11	1	0.17	32	*
2017CPT.01.06.20281.14	Dare	14	SR 1226 MCMULLEN ST	FROM SR 1224 TO SR 1224	1	2	2WU	NO	NO	0.55	18	*	200	20	1.11	564	38		0.67	32	*
2017CPT.01.06.20281.15	Dare	15	SR 1226 MCMULLEN ST	FROM SR 1224 TO CUL-DE-SAC	1	2	2WU	NO	NO	0.11	19	*	20	10	0.22	123	8		0.13	32	*
GRAND TOTAL										3.70		1	940	148	6.64	4,005	269	3	4.49	352	1